

divers plaques de fixati
Multi Anschraubplatte

KEZA-Art. 84784/2
2x M4 und 1x M5
et

X-Mass = 7.5

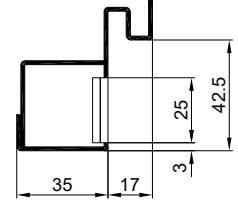

X-Mass = 15.0

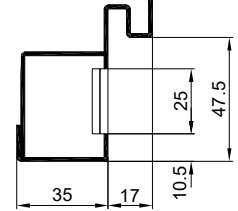

X-Mass = 16.5

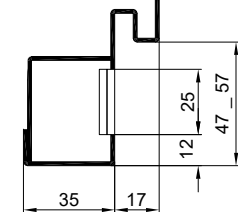

X-Mass = 18.5

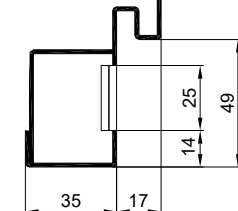

X-Mass = 22.5

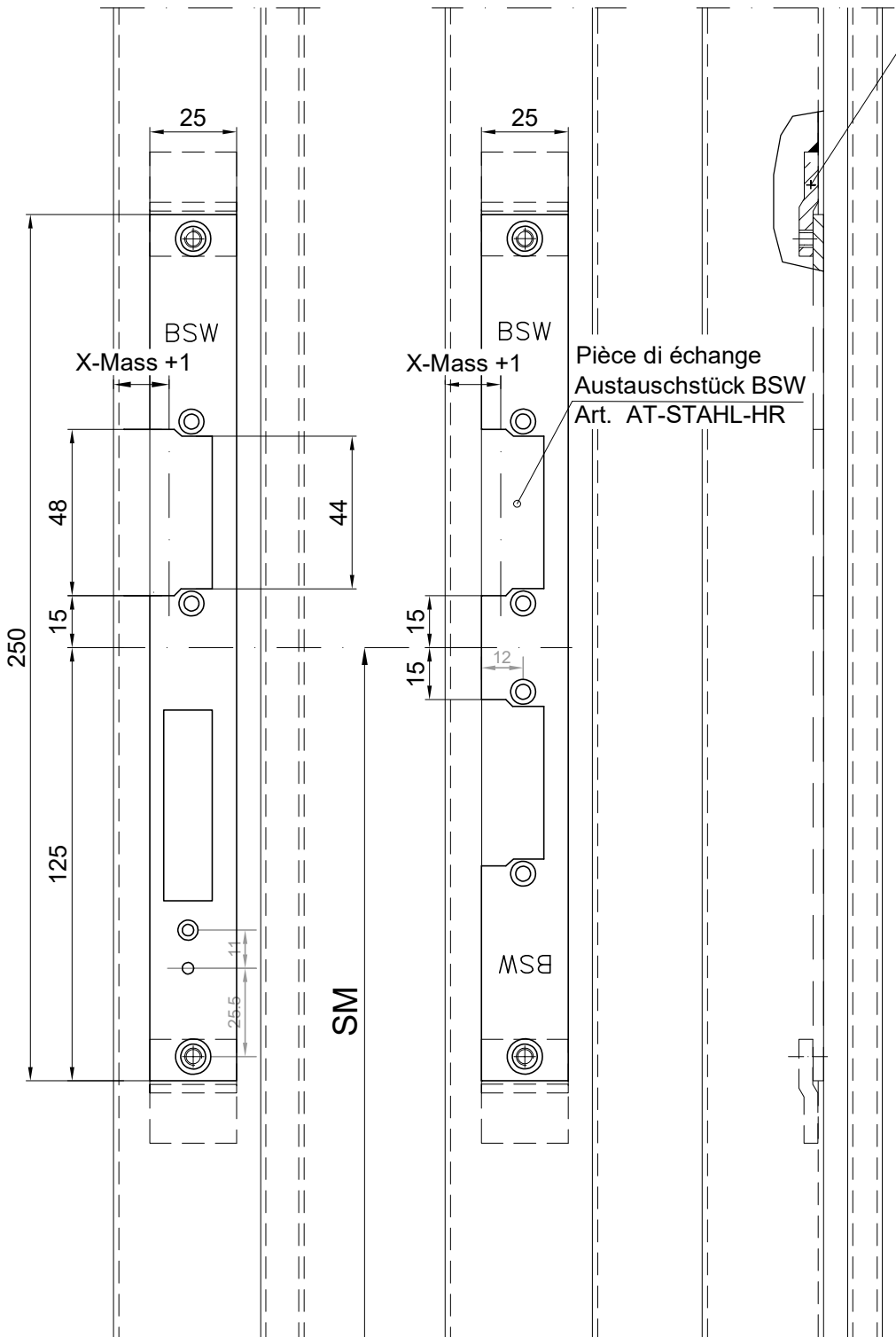
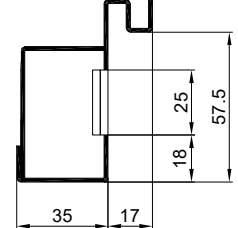

Pièce di échange
Austauschstück BSW
Art. AT-STAHl-HR

BSW Schliessblech HZ 301.102.01 vorgerichtet für RK effeff 878
BSW 2-Fallen-Schliessblech HZ2F 301.818.01
Schliessblech und E-Öffner bauseits
BSW Plaque de gâche HZ 301.102.01 Prépapé effeff 878
BSW Plaque de gâche à 2 pènes HZ2F 301.818.01

CAD A4	Gezeichnet GiPe	Datum 04.10.16
Massstab	Geändert GüSt	Datum 17.05.19

Einbau Schliessblech oder 2-Fallen-SB

Schliessblech BSW für EL. Türöffner mit Fallenführung
Modelle eff-eff ProFix2, Dorma A40xx-Kx (KING)

Montage plaque de gâche on plaque de gâche à 2 pènes
Plaque de gâche BSW pour gâche électrique avec guide de pêne
modèle eff-eff ProFix2, Dorma A40xx-Kx (King)

Typ	SD / UD42	
-----	-----------	--

Plan no.	T9705	
Seite/page		

